

House & Land Package

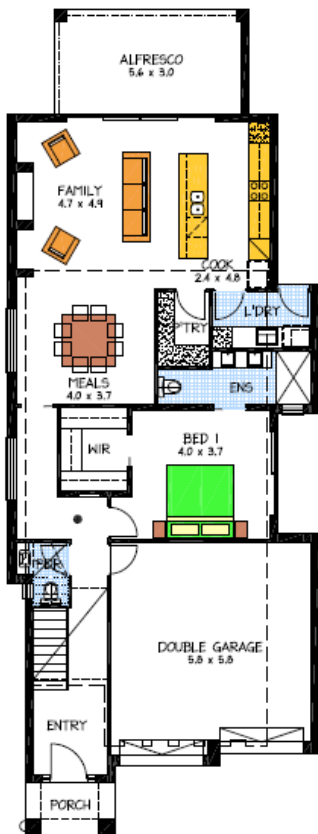
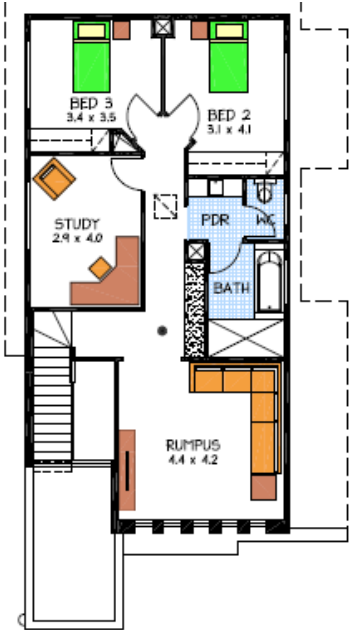

THE HOLDFAST

Lot 117 Barham Ave, Morphettville

This package includes:

- Large four bedroom home
- 2.5 bathrooms
- Second living room
- Walk in pantry to kitchen
- Large alfresco under main roof
- Ensuite with walk in robe to Bed 1
- Soft close joinery throughout
- Timber Laminate and carpet floor coverings
- Automatic Panel Lift garage doors
- Stormwater connection
- Paving to driveway and perimeter path

PACKAGE FROM: \$657,000

HOME: \$342,000 LAND: \$315,000

Disclaimer: All care has been taken in the preparation of this material. No responsibility is taken for any errors or omissions. Details are subject to change without notification. Images for illustration purposes only. E&EO.

FOR THIS OFFER CALL

TIFFANY: 0422 072 598

Because trust is a must

www.rosdalehomes.com.au