

HOUSE AND LAND PACKAGE



The Kyton 152 at Lakeside – From \$302,000 (House and Land)

To Suit:
12.5 x 30m Allotment

Package includes:

- Built to Rossdale Sovereign Specification
- Displayed front elevation including render and stonework ***** (Optional Extra) *****
- Double Roller Door
- Stainless Steel Westinghouse appliances including dishwasher
- Lakeside Encumbrances
- Foundations Allowance (13,900)
- Land (\$137,000)

KYTON - ANDREWS FARM

Areas (m ²)	
Living	152.662
Garage	37.520
Porch	1.399
Total	191.581

20.62 SQUARES
11.51 x 20.19 DEEP

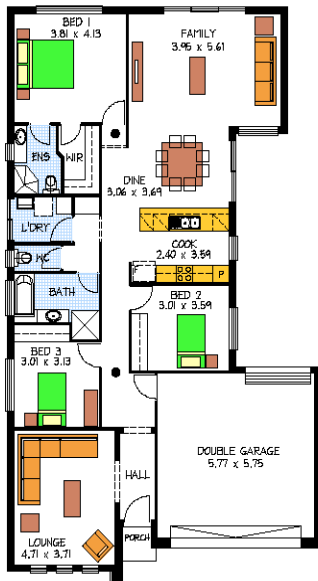

For more details contact-

Vanda Goodwin
0409 999 007

Email: vanda@rossdalehomes.com.au