

HOME AND LAND PACKAGE



MARDEN

Features include.

- .. *Northgate Display* building schedule.
- ◆ Rendered front elevation.
- ◆ Colorbond or tiled roof .
- ◆ Portico to front elevation.
- ◆ 2400 mm ceiling height throughout.
- ◆ 3 large Bedrooms.
- ◆ Master Bedroom with Ensuite and WIR.
- ◆ Electric fan forced underbench oven and gas cooktop plus dishwasher.
- ◆ Linen cupboard to Bathroom.
- ◆ Insulation to external walls and ceilings.
- ◆ 1000 l rain water tank to 1 toilet.
- ◆ Single Garage with roller door.
- ◆ Stormwater to kerb allowance, allow \$ 2,500.
- ◆ Additional site cost allowance, \$8,000

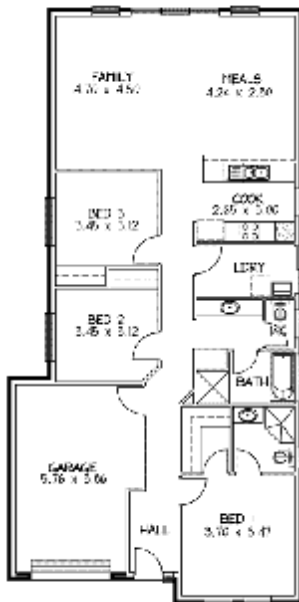

Land

- ◆ To the value of \$ 123,000

Options — not included in price.

- ◆ Floor coverings \$ 8,000
- ◆ Rear landscaping \$ 4,000
- ◆ Concrete driveway allowance \$ 2,000.
- ◆ Concrete perimeter path allowance. \$ 3,500
- ◆ Evaporative cooling \$ 4,500

"Allowance" pricing may vary once Engineering has been completed

Built on land at Lakeside
Lot 1250 Chateau Ave or similar

House and Land from

\$ 269,500.00 .



for further details please contact:

DAVID BIGG - 0412 0999 66
SHARON BOLZON - 0403 468 287

GBLG8104, E&OE Wednesday, November 12, 2008 Prices subject to change with out notice.