



Home & Land Packages



THE SEACOMBE

LOT 673 ASHFILED ST
'BLUESTONE' MOUNT BARKER

This package includes:

- 520m² of land in the lovely Bluestone estate in Mount Barker
- The Seacombe courtyard built to Rossdale Homes Sovereign Specifications
- 4 bedroom plan with double garage and 2 living areas
- Bed 1 with his and hers mirrored built in robes and a fantastic ensuite
- Beds 2 + 3 with mirrored built in robes
- Automatic panel lift doors to garage with internal access
- All services and connections have been allowed for
- Healthy footings allowance including all soil removal from site
- Front elevation is rendered and painted allowing 2 colors
- Instantaneous hot water system
- 25 Year Structural Warranty
- Absolute Fixed Price Contract with no hidden costs
- More options available for this package upon request

PACKAGE FROM: **\$403,000**

HOME: **\$216,000** LAND: **\$187,000**

Disclaimer: All care has been taken in the preparation of this material. No responsibility is taken for any errors or omissions. Details are subject to change without notification. Images for illustration purposes only. E&EO.

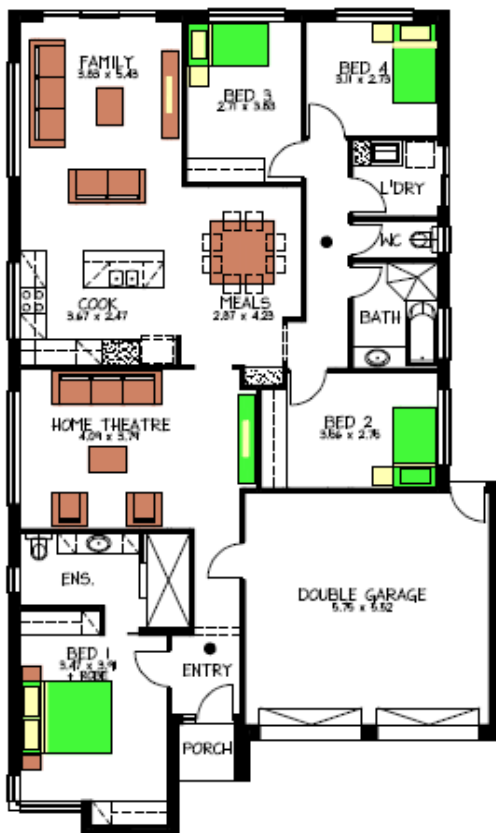

FOR THIS OFFER CALL
BRAD: 0421 940 398

P: 08 8433 2000 www.rossdalehomes.com.au

 *Because trust is a must.*
**ROSSDALE
HOMES**