



Home & Land Packages



THE ST GEORGES

LOT 12 RUSHTON COURT 'THE PINES'
LITTLEHAMPTON

This package includes:

- 600m² of land in the beautiful township of Littlehampton
- Rossdale Homes award winning St Georges courtyard built to Sovereign specifications
- All services have been allowed for including septic to CED and LPG bottle ready
- Bushfire requirements have been allowed for including sarking under the colorbond roof
- Front elevation with Queen Anne Bay window including rendering and painting with tooled quoins to corners
- Master bedroom with ensuite and WIR with BIR to bed 2
- Double garage with automatic roller doors and internal access
- Ceiling, external wall and internal insulation is included
- 25 Year Structural Warranty
- Absolute Fixed Price Contract with no hidden extras
- More options available for this package on request
- Land component by Adcock Real Estate Balhannah RLA 66526

PACKAGE FROM: **\$410,000**

Disclaimer: All care has been taken in the preparation of this material. No responsibility is taken for any errors or omissions. Details are subject to change without notification. Images for illustration purposes only. E&EO.

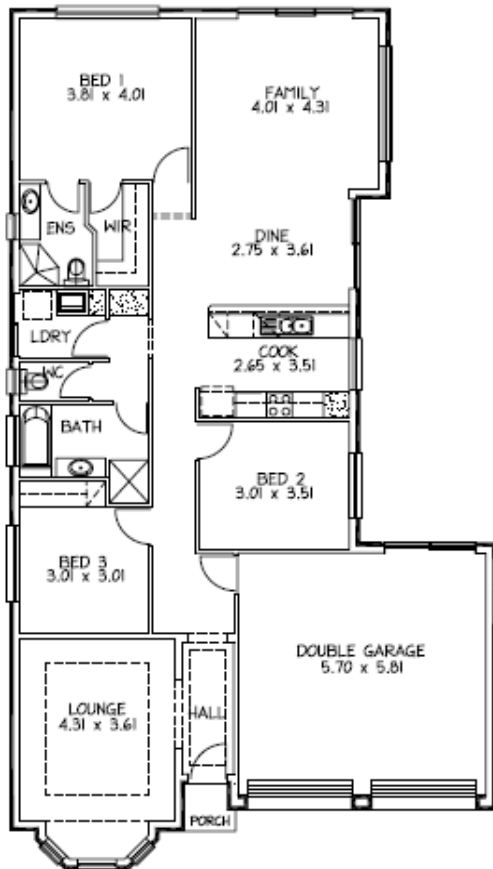

FOR THIS OFFER CALL
BRAD: 0421 940 398

P: 08 8433 2000 www.rossdalehomes.com.au

ADCOCK
REAL ESTATE
ESTABLISHED 1887



Because trust is a must.
ROSSDALE
HOMES