



Because trust is a must

# Fixed Price House & Land Package



AREAS m<sup>2</sup>

LIVING	188.234
GARAGE	39.102
VERANDAH	18.876
TOTAL	246.212

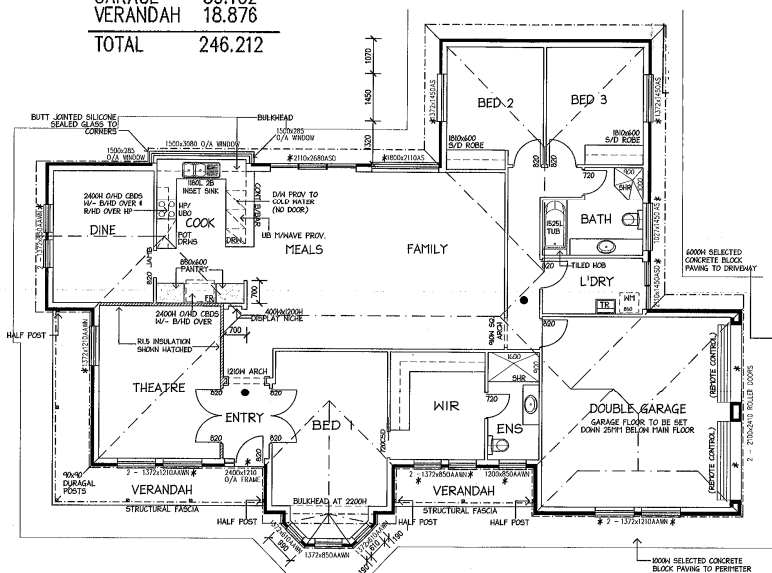

## THE WILLUNGA LOT 237 SPRINGVIEW TCE SPRINGLAKE, MT BARKER

This package includes:

- Absolute fixed price contract
- Full engineering footings report
- Six-star energy rating report
- All developer encumbrances
- Stormwater
- Paving to paths and driveway
- Façade as per image
- Tiled verandah
- Timber Laminate and Carpet floor coverings
- 812sq meter land
- Titles available

**FIXED PRICE**

**PACKAGE: \$506,969**

**HOME: \$276,969 LAND: \$230,000**

Disclaimer: All care has been taken in the preparation of this material. No responsibility is taken for any errors or omissions. Details are subject to change without notification. Images for illustration purposes only. E&EO.

FOR THIS OFFER CALL

**TIFFANY 0422 072 598**

*Because trust is a must*

[www.rossdalehomes.com.au](http://www.rossdalehomes.com.au)