

House & Land Package

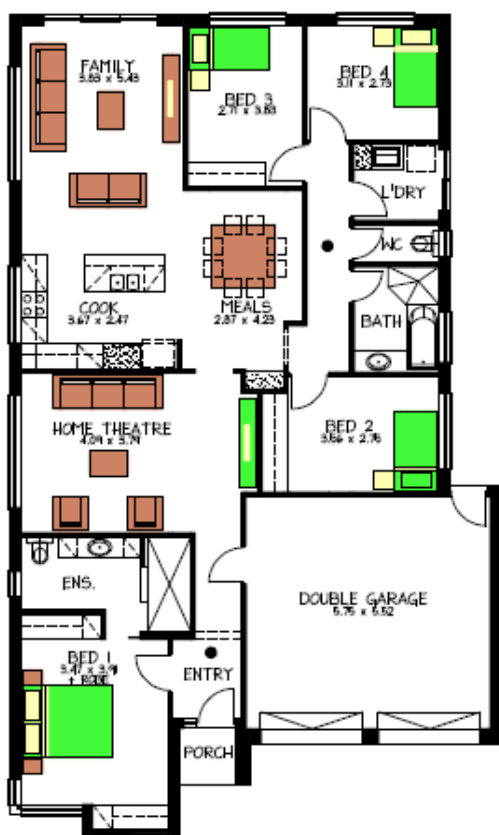

SEACOMBE

5A CLIFFORD STREET
SOUTH BRIGHTON

This package includes:

- Rossdale Seacombe Design in Sovereign Spec
- 2.7m ceilings
- Entertainers Kitchen with s/steel appliances and overhead cupboards
- Deluxe ensuite with 3m ceilings
- Stunning Façade as shown with render and western red cedar
- Bedrooms 1,2,3 BIR
- Double garage with remote panel lift door and internal access
- Generous footing allowance

PACKAGE FROM: \$ 542,500

HOME: \$202,500 LAND: \$340,000

Images for illustration purposes only.

FOR THIS OFFER CALL

JOHN 0423 337 020

Because trust is a must

www.rossdalehomes.com.au